

LOEWS HÔTEL VOGUE

ROOM	DIMENSIONS			CAPACITY			
	FEET/SQUARE FEET	MÈTRES	CEILING HT.(FT/M)	THEATRE	CLASSROOM	RECEPTION	BANQUET
LOBBY LEVEL							
PARIS BALLROOM (I+II)	66 x 44 / 2904	20.1 x 13.4	10'	250	160	350	240
PARIS I	34 x 44 / 1496	10.4 x 13.4	10'	140	80	200	120
PARIS II	32 x 44 / 1408	9.7 x 3.4	10'	120	64	150	120
LYON (I+II)	24 x 31 / 744	7.3 x 9.4	10'	80	48	80	70
LYON I	24 x 15 / 360	7.3 x 4.6	10'	30	24	30	30
LYON II	24 x 16 / 384	7.3 x 4.9	10'	40	24	40	30
SECOND FLOOR							
BOURNEMOUTH	20 x 14 / 280	6.0 x 4.3	8'	Permanent Boardroom Table, seating for 10			
ISSY	23 x 15 / 345	7.0 x 4.6	8'	Permanent Boardroom Table, seating for 14			
OXFORD	23 x 15 / 345	7.0 x 4.6	8'	Permanent Boardroom Table, seating for 16			
EDIMBOURG (I+II)	21 x 37 / 777	6.4 x 11.3	8'	54	35	70	60
EDIMBOURG I	21 x 18 / 378	6.4 x 5.5	8'	30	18	30	30
EDIMBOURG II	21 x 19 / 399	6.4 x 5.8	8'	30	18	30	30
FLORENCE (I+II+III)	22 x 51 / 1122	6.7 x 15.5	8'	90	60	120	110
FLORENCE I	22 x 15 / 330	6.7 x 4.6	8'	20	17	20	20
FLORENCE II	22 x 18 / 396	6.7 x 5.5	8'	30	22	30	30
FLORENCE III	22 x 18 / 396	6.7 x 5.5	8'	30	22	30	30

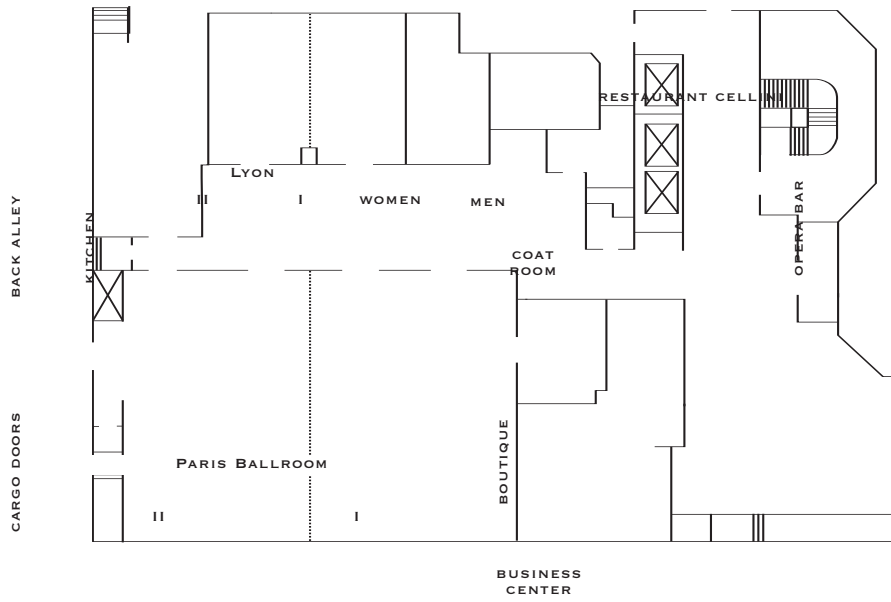

LOBBY LEVEL

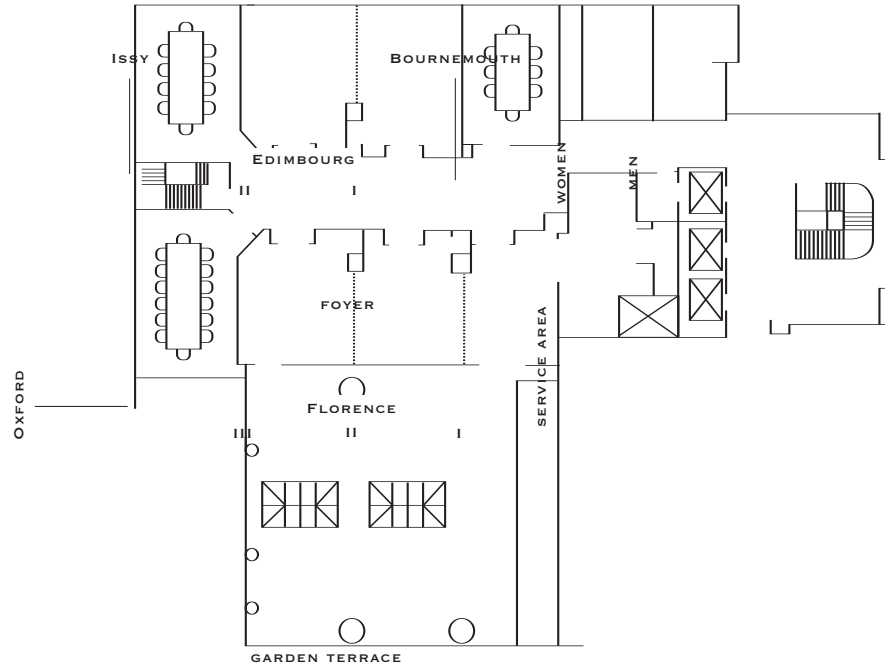

SECOND FLOOR